

NPD4-100-500-K5-7

4-Way, 0.1~0.5GHz

Features:

- * Small Size
- * Low Insertion Loss

Applications:

- * Amplifiers
- * Mixers
- * Antennas
- * Laboratory Test

Electrical

| | |
|--------------------|------------------------------------|
| Frequency: | 0.1~0.5GHz |
| Insertion Loss: | 0.6dB max. |
| Input VSWR: | 1.3 max. |
| Output VSWR: | 1.2 max. |
| Isolation: | 20dB min. |
| Amplitude Balance: | 0.2dB max. |
| Phase Balance: | $\pm 2^\circ$ |
| Impedance: | 50 Ω |
| Average Power: | 500W max. 100W max. as combiner |

Mechanical

| | |
|----------------------|--------------------------------------|
| Size ^{*1} : | 284*228*35mm 11.181*8.976*1.378in |
| Weight: | 3600g |
| Connectors: | 7/16 DIN Female |
| Mounting: | 4- Φ 4.4mm through-hole |

[1] Exclude connectors.

Environmental

| | |
|------------------------|-----------|
| Operation Temperature: | -35~+75°C |
|------------------------|-----------|

Outline Drawings

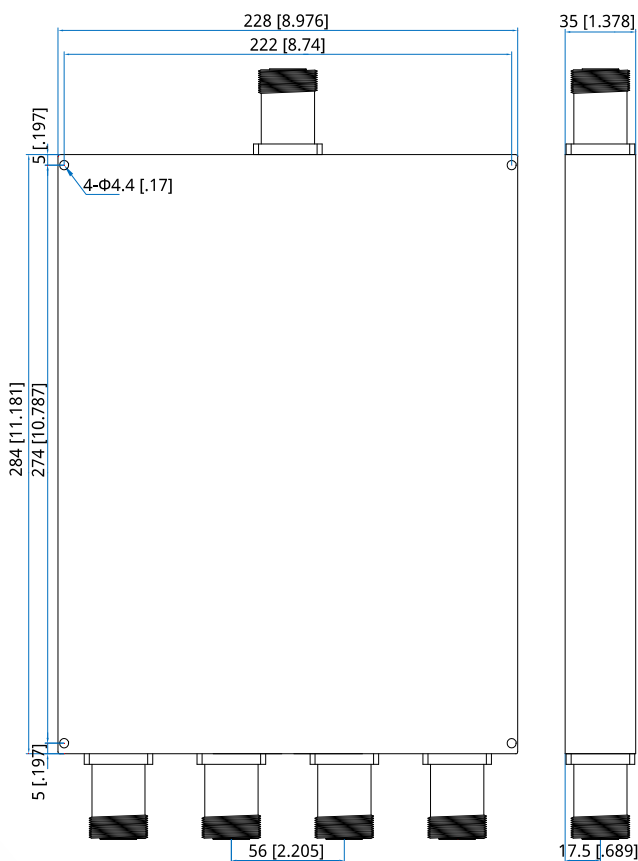

Unit: mm [in]

Tolerance: ± 0.5 mm [± 0.02 in]

How To Order

NPD4-100-500-K5-7

Customization is available upon request.