

NPD4-4000-12000-20-S

4-Way, 4~12GHz

Features:

- * Small Size
- * Low Insertion Loss

Applications:

- * Amplifiers
- * Mixers
- * Antennas
- * Laboratory Test

Electrical

Frequency:	4~12GHz
Insertion Loss:	1.2dB max.
Input VSWR:	1.4 max.
Output VSWR:	1.3 max.
Isolation:	18dB min.
Amplitude Balance:	±0.2dB
Phase Balance:	±4°
Impedance:	50Ω
Average Power:	20W max. 1W max. as combiner

Mechanical

Size ^{*1} :	60*54*10mm 2.362*2.126*0.394in
Weight:	88g
Connectors:	SMA Female
Mounting:	4-Φ2.8mm through-hole

[1] Exclude connectors.

Environmental

Operation Temperature:	-45~+85°C
------------------------	-----------

Outline Drawings

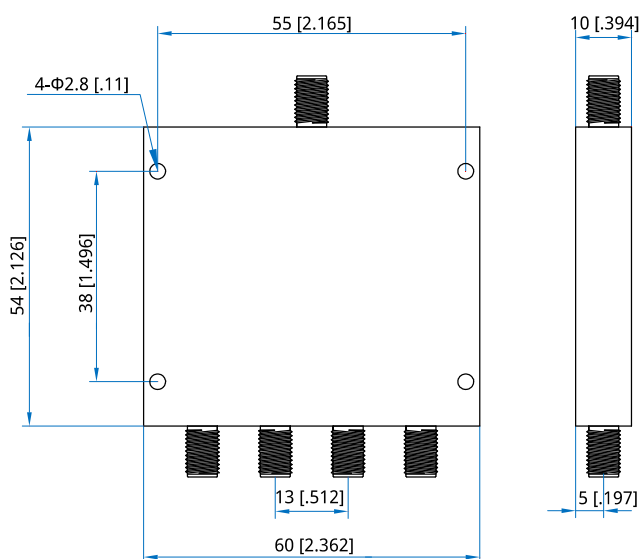

Unit: mm [in]

Tolerance: ±0.5mm [±0.02in]

How To Order

NPD4-4000-12000-20-S

Customization is available upon request.