

NPD2-800-3800

2-Way, 0.8~3.8GHz

Features:

- * Small Size
- * Low Insertion Loss

Applications:

- * Amplifiers
- * Mixers
- * Antennas
- * Laboratory Test

Electrical

Frequency:	0.8~3.8GHz
Insertion Loss:	0.9dB max.
Input VSWR:	1.3 max.
Output VSWR:	1.2 max.
Isolation:	20dB min.
Amplitude Balance:	±0.2dB
Phase Balance:	±3°
IP Grade:	IP67
Impedance:	50Ω
Average Power:	200W max. 10W max. as combiner

Mechanical

Size*1: 95*58*30mm
3.74*2.283*1.181in

RF Connectors: 7/16 DIN Female

[1] Exclude connectors.

Environmental

Operation Temperature: -30~+70°C

Outline Drawings

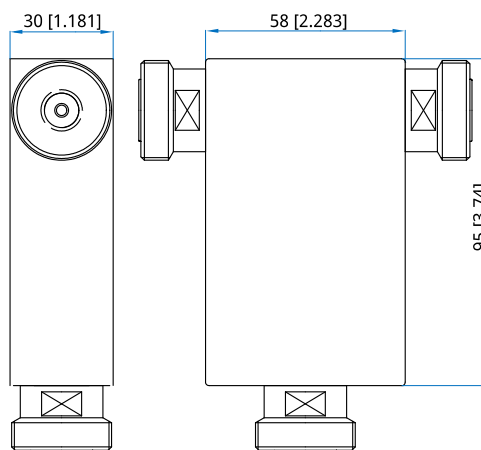

Unit: mm [in]

Tolerance: ±0.5mm [±0.02in]

How To Order

NPD2-800-3800

Customization is available upon request.