

## NWD-22

### Broadband & High Sensitivity

#### Features:

- \* Broadband
- \* High Sensitivity

#### Applications:

- \* Telecom
- \* Instrumentation
- \* Laboratory Test
- \* Radar

#### Electrical

Frequency Range:	33~50GHz
Sensitivity:	300mV/mW
Flatness:	±1.8dB max.
Polarity:	Negative
Input Power Without Damage:	20dBm

#### Mechanical

Size:	30*42.5*17mm 1.181*1.673*0.669in
Weight:	150g max.
Input Connector:	WR-22
Output Connector:	SMA Female

#### Environmental

Operating Temperature:	0~+50°C
Non-operating Temperature:	-20~+70°C

#### Outline Drawings

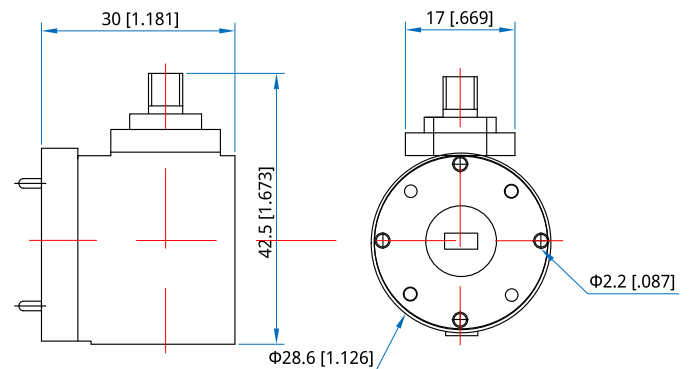

Unit: mm [in]

Tolerance: ±0.2mm [±0.008in]

#### How To Order

**NWD-22**

Customization is available upon request.