

## NCS-FL2B-086-1

### SMA Female

Features:  
\* Low VSWR

Applications:  
\* Wireless  
\* Radar  
\* Instruments  
\* Electronics

#### Electrical

Frequency:	DC~18GHz
VSWR:	1.25 max.
Impedance of Dielectric:	5000MΩ min.
Voltage Withstand:	750V DC min
Impedance:	50Ω

#### Mechanical

RF Connector:	SMA Female
Mating Cable:	NH280, ND086, NE086, RG316, RG316D
Outer Conductor:	Brass

#### How To Order

**NCS-FL2B-086-1**

Customization is available upon request.

#### Outline Drawings

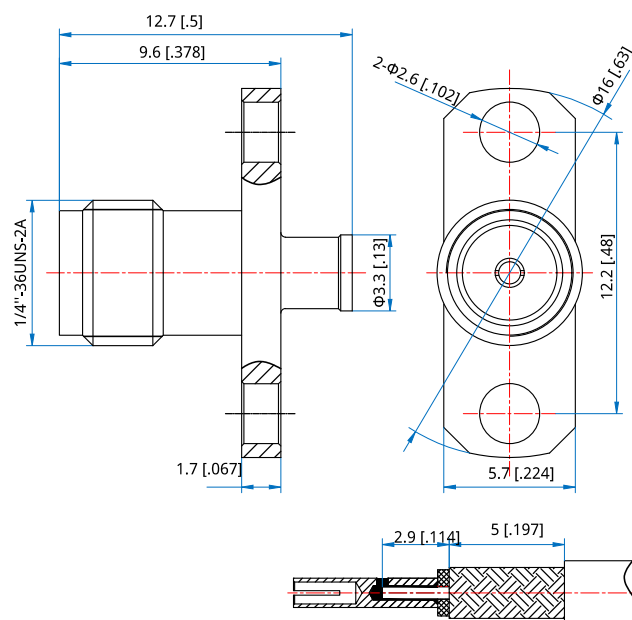

Unit: mm [in]

Tolerance: ±0.2mm [±0.008in]