

## NCW-MCB-316-1

### SSMC Male Crimp

Features:  
\* Low VSWR

Applications:  
\* Wireless  
\* Radar  
\* Instruments  
\* Electronics

#### Electrical

Frequency:	DC-6GHz
Impedance of Dielectric:	5000MΩ min.
Voltage Withstand:	750V DC
Impedance:	50Ω

#### Mechanical

RF Connector:	SSMC male
Mating Cable:	RG316
Body:	Gold Plated Brass
Dielectric:	PTFE
Inner Conductor:	Gold Plated Beryllium Copper

#### Outline Drawings

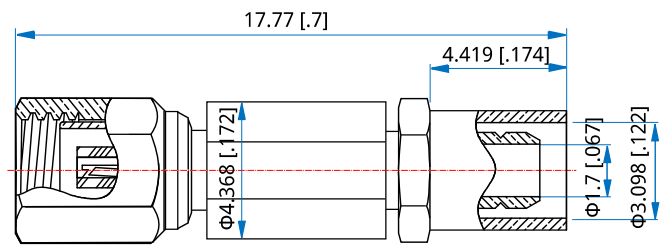

Unit: mm [in]

Tolerance:  $\pm 0.2\text{mm}$  [ $\pm 0.008\text{in}$ ]

#### How To Order

##### NCW-MCB-316-1

Customization is available upon request.