

NCM-MCB-R500-1

MCX Male

Features:
* Low VSWR

Applications:
* Wireless
* Radar
* Instruments
* Electronics

Electrical

Frequency:	DC~6GHz
Impedance of Dielectric:	5000MΩ min.
Voltage Withstand:	1000V
VSWR:	1.3 max.
Impedance:	50Ω

Mechanical

RF Connector:	MCX male
Mating Cable:	NR500
Outer Conductor:	Gold plated brass
Dielectric:	PTFE
Inner Conductor:	Gold plated brass

Environmental

Temperature:	-55~+165°C
--------------	------------

Outline Drawings

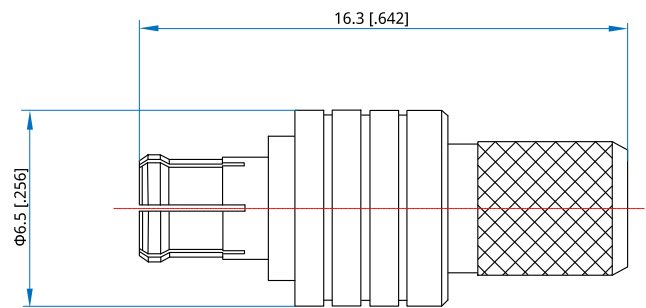

Unit: mm [in]
Tolerance: ± 0.2 mm [± 0.008 in]

How To Order

NCM-MCB-R500-1

Customization is available upon request.