

## NBM-18000-40000

### 18~40GHz

#### Features:

- \* Low Conversion Loss
- \* High Isolation

#### Applications:

- \* Wireless
- \* Transceiver
- \* Laboratory Test
- \* Broadcast

#### Electrical

RF Frequency:	18~40GHz
LO Frequency:	26~33GHz
LO Input Power:	13dBm typ.
IF Frequency:	6~8GHz
Conversion Loss:	10dB typ.
RF/IF Input Power:	15dBm max.
Isolation (LO, RF):	41dB typ.
Isolation (LO, IF):	32dB typ.
Isolation (RF, IF):	17dB typ.

#### Mechanical

Size <sup>*1</sup> :	17.5*16.5*8mm 0.689*0.65*0.315in
IF Connectors:	SMA Female
RF/LO Connectors:	2.92mm Female
Mounting:	4*Φ2.2mm through-hole

[1] Exclude connectors.

#### Environmental

Operating Temperature: -40~+85°C

#### Outline Drawings

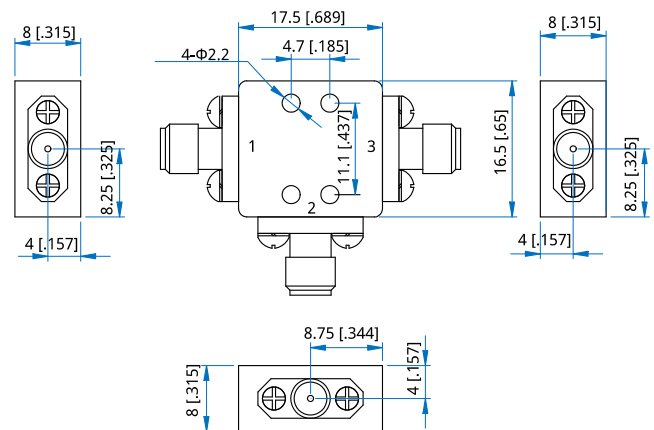

Unit: mm [in]

Tolerance: ±0.2mm [±0.008in]

#### How To Order

**NBM-18000-40000**

Customization is available upon request.