

## NCP-FL2B-P45-01

SMP Connector, DC~2GHz

Features:  
\* Low VSWR

Applications:  
\* Wireless  
\* Radar  
\* Instruments  
\* Electronics

### Electrical

Frequency:	DC~2GHz
Impedance of Dielectric:	5000MΩ min.
Voltage Withstand:	500V DC
Impedance:	50Ω

### Mechanical

RF Connector:	SMP Female
Mating Life Cycle:	1000 cycles@Smooth Bore 500 cycles@Limited Detent 100 cycles@Full Detent
Outer Conductor:	Gold Plated Brass
Dielectric:	PTFE
Inner Conductor:	Gold Plated Beryllium Copper

### Environmental

Temperature:	-55~+125°C
--------------	------------

### Outline Drawings

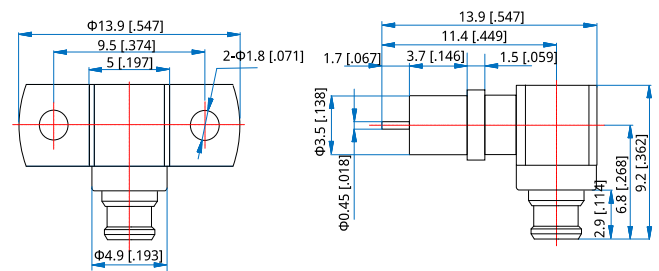

Unit: mm [in]

Tolerance:  $\pm 0.2\text{mm}$  [ $\pm 0.008\text{in}$ ]

### How To Order

**NCP-FL2B-P45-01**

Customization is available upon request.