

NCA-FL2G-M

SSMA Connector, DC~40GHz

Features:
* Low VSWR

Applications:
* Wireless
* Radar
* Instruments
* Electronics

Electrical

Frequency:	DC~40GHz
VSWR:	1.2 max.
Impedance of Dielectric:	1000MΩ min.
Impedance of Inner Conductor:	5mΩ max.
Impedance of Outer Conductor:	2.5mΩ max.
Voltage Withstand:	750V DC
Impedance:	50Ω

Mechanical

RF Connector:	SSMA Female
Mating Life Cycle:	500 cycles
Outer Conductor:	Passivated SUS303 Stainless Steel
Dielectric:	PEI & PTFE
Inner Conductor:	Gold Plated Beryllium Copper

Environmental

Temperature:	-55~+165°C
--------------	------------

Outline Drawings

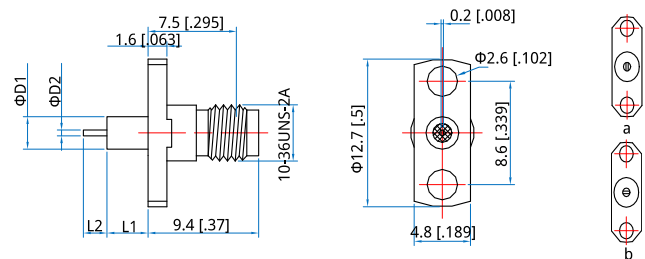

Part Number	$\Phi D1$	$\Phi D2$	L1	L2	
NCA-FL2G-M60-01	2.8 [.11]	0.6 [.024]	3.1 [.122]	2 [.079]	a
NCA-FL2G-M60-02	2.8 [.11]	0.6 [.024]	3.1 [.122]	2 [.079]	b

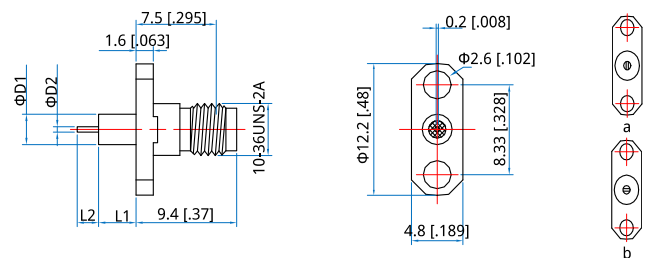

Part Number	$\Phi D1$	$\Phi D2$	L1	L2	
NCA-FL2G-M60-03	2.8 [.11]	0.6 [.024]	3.1 [.122]	2 [.079]	a
NCA-FL2G-M60-04	2.8 [.11]	0.6 [.024]	3.1 [.122]	2 [.079]	b

Unit: mm [in]
Tolerance: $\pm 0.2\text{mm}$ [$\pm 0.008\text{in}$]