

**NVLC-SF-1**  
SMA, DC~18GHz

### Features:

- \* Low VSWR
- \* No welding
- \* Reusable
- \* Easy installation

Applications:

- \* Laboratory Test

## Electrical

Frequency:	DC~18GHz
VSWR:	1.3 max.
Impedance:	50Ω

## Mechanical

RF Conductor:	SMA Female
Inner Conductor:	Gold plated beryllium copper
Dielectric:	PTFE
Outer Conductor:	Nickel Plated Brass

## Environmental

Temperature: -55~+165°C

## How To Order

## NVLC-SF-1

Customization is available upon request.

## Outline Drawings

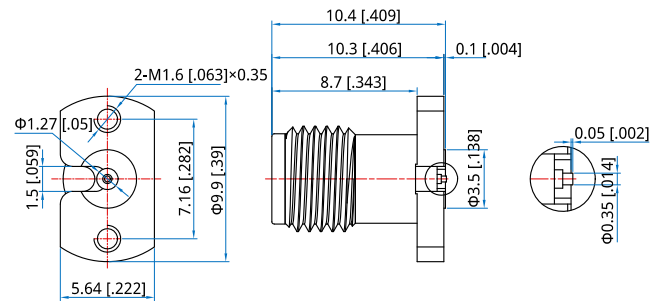

Unit: mm [in]

Tolerance:  $\pm 0.2\text{mm}$  [ $\pm 0.008\text{in}$ ]