

# **NAL2L2** L12 to L12

Features:  
\* Low VSWR

Applications:  
\* Wireless  
\* Transmitter  
\* Laboratory Test  
\* Radar

## **Electrical**

Frequency: DC~6GHz  
VSWR: 1.2 max.  
Impedance: 50Ω

## **Mechanical**

RF Connectors: L12  
Mating Life Cycle: 500 cycles  
Outer Conductor: Ternary alloy plated brass  
Dielectric: PTFE  
Inner Conductor: Gold plated beryllium copper

## **Environmental**

Temperature -55~+165°C

## **Outline Drawings**

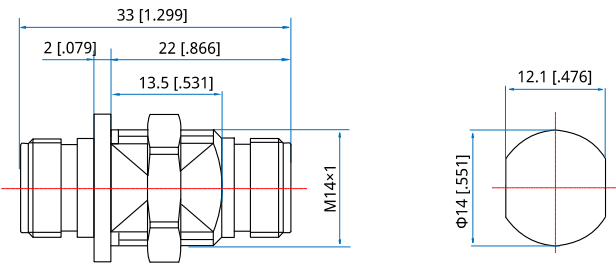

Outline A

Unit: mm [in]  
Tolerance: ±0.2mm [±0.008in]

## **How To Order**

**NAL2L2H-FF** - L12(f) to L12 (f), Flange mount, Outline A

Customization is available upon request.