

NA55

1.35mm to 1.35mm

Features:
* Low VSWR

Applications:
* Wireless
* Transmitter
* Laboratory Test
* Radar



Electrical

Frequency:	DC~90GHz
VSWR:	1.3 max.
Impedance:	50Ω

Mechanical

RF Connectors:	1.35mm
Mating Life Cycle:	500 cycles
Outer Conductor:	Passivated Stainless Steel
Dielectric:	PEI
Inner Conductor:	Gold plated beryllium copper

Environmental

Temperature:	-55~+165°C
--------------	------------

Outline Drawings

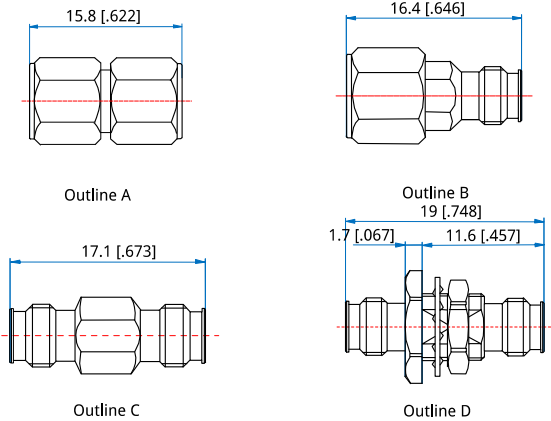

How To Order

- NA55-MM** - 1.35mm(m) to 1.35mm(m), Outline A
- NA55-MF** - 1.35mm(m) to 1.35mm(f), Outline B
- NA55-FF** - 1.35mm(f) to 1.35mm(f), Outline C
- NA55H-FF** - 1.35mm(f) to 1.35mm(f), Bulk head, Outline D

Unit: mm [in]
Tolerance: ±0.2mm [±0.008in]

Customization is available upon request.