

## NDC2123B

### High Power, High Isolation

#### Features:

- \* High Power
- \* High Isolation
- \* Low Insertion Loss
- \* Low VSWR

#### Applications:

- \* Wireless
- \* Radar
- \* Laboratory Test

#### Description

NDC2123B series Drop-In Circulators cover frequency range 4~8GHz. High power, high isolation and low insertion loss make it ideal for a lot of applications like amplifiers, transceivers, etc.

#### Specifications

Frequency (MHz)	Bandwidth (MHz)	Insertion Loss (dB Max.)	Isolation (dB Min.)	VSWR (Max.)	Average Power (W)	Temperature (°C)
4000~8000	4000	0.60	18.0	1.35	60	0~+60

#### Outline Drawings

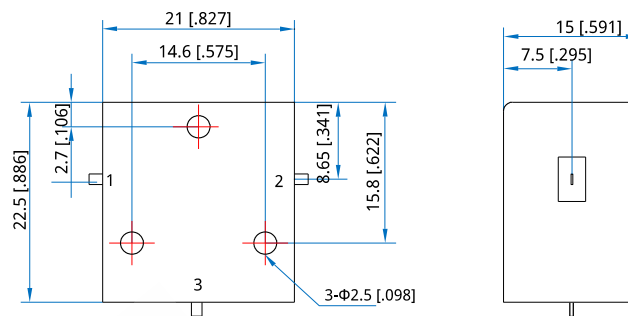

Unit: mm [inch]      Tolerance: ±0.2mm [±0.008in]

#### Mechanical

Size\*1: 21\*22.5\*15mm  
0.827\*0.886\*0.591in

Connector Type: Strip line

Mounting: 3-Φ2.5mm through-hole

[1] Exclude connectors

#### How To Order

**NDC2123B-X-Y-Z**

X: Start frequency in MHz

Y: Stop frequency in MHz

Z: Average Power in W

#### Examples:

To order a NDC2123B series Circulator, 4~8GHz, 60W, specify NDC2123B-4000-8000-60.

Customization is available upon request.