

## NDC3030B

### High Power, High Isolation

#### Features:

- \* High Power
- \* High Isolation
- \* Low Insertion Loss
- \* Low VSWR

#### Applications:

- \* Wireless
- \* Radar
- \* Laboratory Test

#### Description

NDC3030B series Drop-In Circulators cover frequency range 2~6GHz. High power, high isolation and low insertion loss make it ideal for a lot of applications like amplifiers, transceivers, etc.

#### Specifications

Frequency (MHz)	Bandwidth (MHz)	Insertion Loss (dB Max.)	Isolation (dB Min.)	VSWR (Max.)	Average Power (W)	Temperature (°C)
2000~6000	4000	1.7	12	1.6	20	-40~+70

#### Outline Drawings

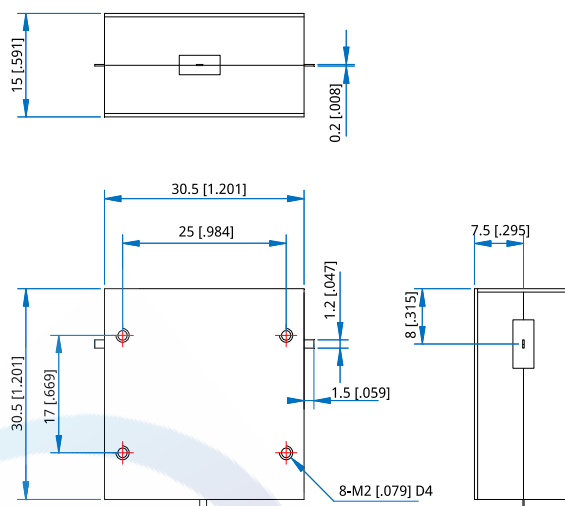

Unit: mm [inch]

Tolerance:  $\pm 0.2\text{mm}$  [ $\pm 0.008\text{in}$ ]

#### Mechanical

Size<sup>\*1</sup>: 30.5\*30.5\*15mm  
1.201\*1.201\*0.591in

Connector Type: Strip line

Mounting: 8-M2mm deep 4 mm

[1] Exclude connectors

#### Direction Naming Rules:

- 1 - Clockwise
- 2 - Anticlockwise

#### How To Order

**NDC3030B-W-X-Y-Z**

W: Start frequency in MHz

X: Stop frequency in MHz

Y: Average Power in W

Z: Direction type

#### Examples:

To order a NDC3030B series Circulator, 2~6GHz, 20W, Clockwise, specify NDC3030B-2000-6000-20-1.

Customization is available upon request.