

NASM SMA to MCX

Features:
* Low VSWR

Applications:
* Wireless
* Transmitter
* Laboratory Test
* Radar



Electrical

Frequency: DC~6GHz
VSWR: 1.2 max.
Impedance: 50Ω

Mechanical

RF Connectors: SMA
MCX
Mating Life Cycle: 500 cycles
Outer Conductor: Gold Plated Brass
Dielectric: PTFE
Inner Conductor: Gold Plated Beryllium Copper

Environmental

Temperature: -55~+165°C

How To Order

NASM-MM - SMA(m) to MCX(m), Outline A

NASM-MF - SMA(m) to MCX(f), Outline B

NASM-FM - SMA(f) to MCX(m), Outline C

NASM-FF - SMA(f) to MCX(f), Outline D

NASM-FM-1 - SMA(f) to MCX(f), Outline E

NASM-FF-1 - SMA(f) to MCX(f), Outline F

Customization is available upon request.

Outline Drawings

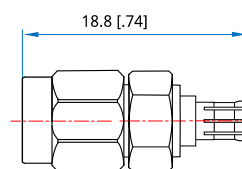

Outline A

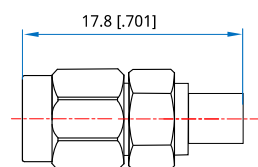

Outline B

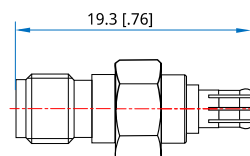

Outline C

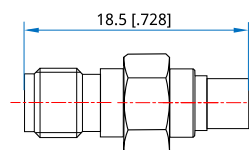

Outline D

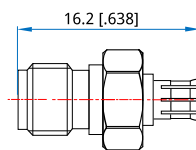

Outline E

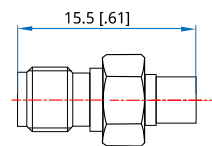

Outline F

Unit: mm [in]

Tolerance: ±0.2mm [±0.008in]