

## NDC1620B

### High Power, High Isolation

#### Features:

- \* High Power
- \* High Isolation
- \* Low Insertion Loss
- \* Low VSWR

#### Applications:

- \* Wireless
- \* Radar
- \* Laboratory Test

#### Description

NDC1620B series Drop-In Circulators cover frequency range 6~18GHz. High power, high isolation and low insertion loss make it ideal for a lot of applications like amplifiers, transceivers, etc.

#### Specifications

Frequency (MHz)	Bandwidth (MHz)	Insertion Loss (dB Max.)	Isolation (dB Min.)	VSWR (Max.)	Average Power (W)	Temperature (°C)
6000~18000	12000	1.5	10	1.9	20	-30~+70
13500~16500	3000	0.6	18	1.3	30	-30~+70

#### Outline Drawings

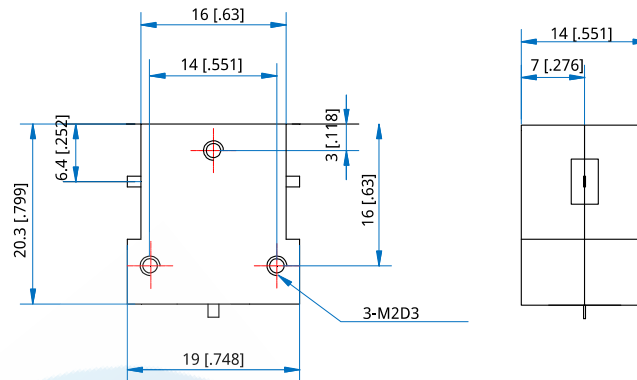

Unit: mm [inch]

Tolerance:  $\pm 0.2\text{mm}$  [ $\pm 0.008\text{in}$ ]

#### Mechanical

Size\*1: 16\*20.3\*14mm

0.63\*0.799\*0.551in

Connector Type: Strip line

Mounting: 3-M2mm deep 3 mm

[1] Exclude connectors

#### Direction Naming Rules:

- 1 - Clockwise
- 2 - Anticlockwise

#### How To Order

##### NDC1620B-W-X-Y-Z

W: Start frequency in MHz

X: Stop frequency in MHz

Y: Average Power in W

Z: Direction type

#### Examples:

To order a NDC1620B series Circulator, 6~18GHz, 20W, Clockwise, specify NDC1620B-6000-18000-20-1.

Customization is available upon request.