

NDC3234A

High Power, High Isolation

Features:

- * High Power
- * High Isolation
- * Low Insertion Loss
- * Low VSWR

Applications:

- * Wireless
- * Radar
- * Laboratory Test

Description

NDC3234A series Drop-In Circulators cover frequency range 2~ 4GHz. High power, high isolation and low insertion loss make it ideal for a lot of applications like amplifiers, transceivers, etc.

Specifications

Frequency (MHz)	Bandwidth (MHz)	Insertion Loss (dB Max.)	Isolation (dB Min.)	VSWR (Max.)	Average Power (W)	Temperature (°C)
2000~4000	2000	0.60	16.0	1.35	10~100	0~+60

Outline Drawings

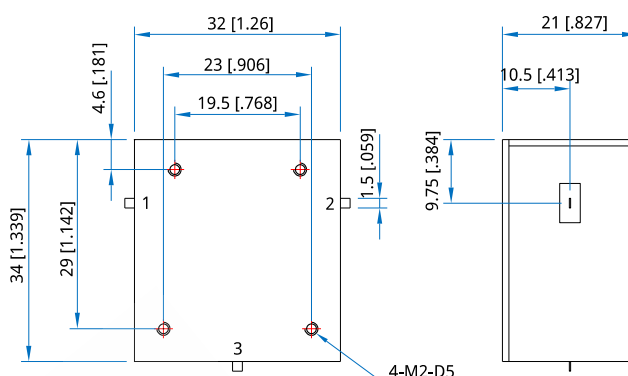

Unit: mm [inch] Tolerance: $\pm 0.2\text{mm}$ [$\pm 0.008\text{in}$]

Mechanical

Size*1: 32*34*21mm
1.26*1.339*0.827in
Connector Type: Strip line
Mounting: 4-M2, depth 5mm

[1] Exclude connectors

How To Order

NDC3234A-X-Y-Z

X: Start frequency in MHz

Y: Stop frequency in MHz

Z: Average Power in W

Examples:

To order a NDC3234A series Circulator, 2000~ 4000MHz, 100W, specify NDC3234A -2000-4000-K1.

Customization is available upon request.