

NAFF F to F

Features:
* Low VSWR

Applications:
* Wireless
* Transmitter
* Laboratory Test
* Radar

Electrical

Frequency: DC~1GHz
VSWR: 1.3 max.
Impedance: 75Ω

Mechanical

RF Connectors: F
Mating Life Cycle: 500 cycles
Outer Conductor: Nickel plated brass
Dielectric: PTFE
Inner Conductor: Gold Plated Beryllium Copper

Environmental

Temperature: -55~+165°C

Outline Drawings

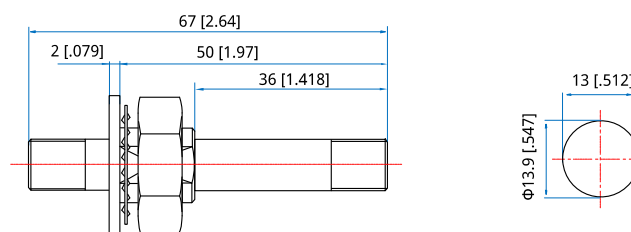

Outline A

Unit: mm [in]
Tolerance: ±0.2mm [±0.008in]

How To Order

NAFFH-FF - F(f) to F(f), Bulk head, Outline A

Customization is available upon request.