

NCT5005

DC~50GHz, 5W

Features:
 * Low VSWR
 * Broadband

Applications:
 * Transmitters
 * Antennas
 * Laboratory Test
 * Impedance Matching

Electrical

Frequency Range: DC~50GHz
 Average Power*1: 5W
 Impedance: 50Ω
 VSWR: 1.4 max.

[1] Derated linearly to 0.25W@120°C.

Mechanical

Connector: 2.4mm
 Weight: 30g
 Housing: Aluminum
 Outer Conductor: Gold plated brass or stainless steel
 Male Inner Conductor: Gold plated brass
 Female Inner Conductor: Gold plated beryllium copper

Environmental

Temperature: -55~+85°C

Outline Drawings

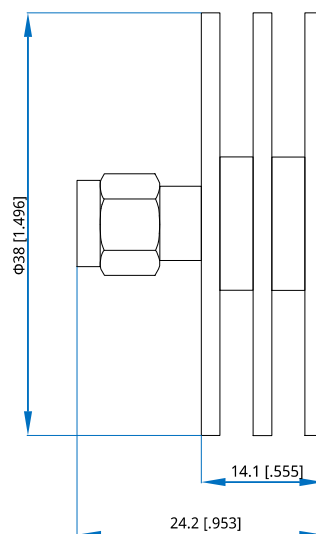

Unit: mm [in]

Tolerance: ±0.5mm [±0.02in]

How To Order

NCT5005-X-Y

X: Frequency in GHz

Y: Connector type

Connector naming rules:

2 - 2.4mm male

2F - 2.4mm female

Examples:

To order a termination, DC-50GHz, 2.4mm male, specify NCT5005-50-2.

Customization is available upon request.