

NWCA -* 2-SF -E WR-62 to SMA Female, End Launch

Features:
* Low VSWR

Applications:
* Wireless
* Transmitter
* Laboratory Test
* Radar

Electrical

Frequency: 11.9~18GHz
VSWR: 1.2 max.
Impedance: 50Ω

Mechanical

Length: 35mm
1.378in
RF Connectors: SMA Female
Interface: WR-62
Flange: FBP140
Material: Aluminium

How To Order

NWCA-62-SF-E

Customization is available upon request.

Outline Drawings

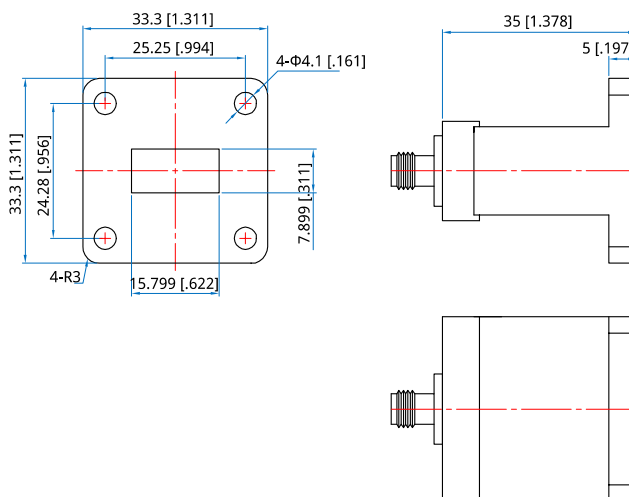

Unit: mm [in]
Tolerance: ±0.2mm [±0.008in]