

NWCA-15- -SF -E WR-159 to SMA female, End launch

Features:
* Low VSWR

Applications:
* Wireless
* Transmitter
* Laboratory Test
* Radar

Electrical

Frequency: 4.64~7.05GHz
VSWR: 1.2 max.
Impedance: 50Ω

How To Order

NWCA-159-SF-E

Customization is available upon request.

Mechanical

Length: 65mm
2.559in
RF Connectors: SMA Female
Interface: WR-159
Flange: FDP58
Material: Aluminium

Outline Drawings

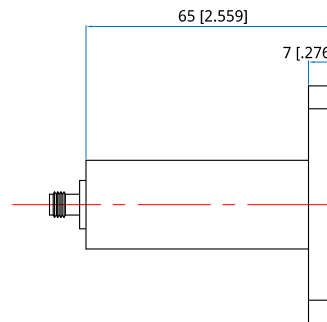
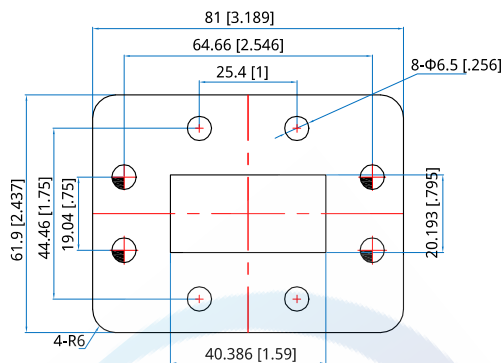

Unit: mm [in] Tolerance: ±0.2mm [±0.008in]