

## N7A0101

DC~1GHz, 1W

### Features:

- \* Low VSWR
- \* High Attenuation Flatness

### Applications:

- \* Wireless
- \* Transmitter
- \* Laboratory Test
- \* Radar

### Electrical

Frequency:	DC~1GHz
Attenuation:	1, 2, 4, 8, 10, 16, 20dB
VSWR:	1.10 max.
Impedance:	75Ω
Average Power <sup>*1</sup> :	1W@25°C
Peak Power <sup>*2</sup> :	0.5KW

[1] Derated linearly to 0.2W@125°C

[2] Pulse width: 5us, duty cycle: 0.2%.

### Attenuation Accuracy

Frequency (GHz)	Attenuation Accuracy (±dB) vs. Attenuation (dB)			
	1/2/4/8	10	16	20
DC~1	±0.4	±0.5	±0.5	±1.0

### Mechanical

RF Connectors:	F
Housing:	Aluminum
Outer Conductor:	Nickel plated brass
Male Inner Conductor:	Gold plated brass
Female Inner Conductor:	Gold plated brass

### Environmental

Temperature:	-55~+125°C
--------------	------------

### Outline Drawings

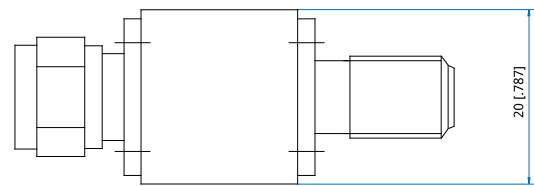
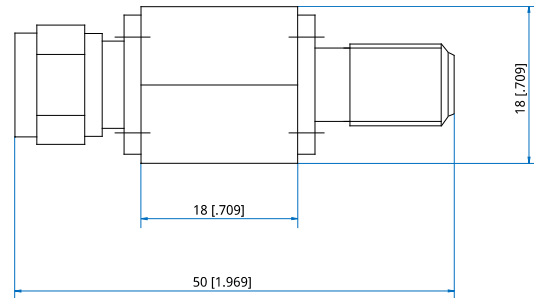

Outline A

Unit: mm [in]

Tolerance: ±5%

### How To Order

**N7A0101-X-Y-Z**

X: Frequency in GHz

Y: Attenuation in dB

Z: Connector type

Connector naming rules:

F - F

Examples:

To order an attenuator, DC~1GHz, 10dB, F male to F female, specify N7A0101-1-10-F.